



A helicopter ride during Luverne's 2015 Buffalo Days weekend allowed for this aerial photograph of the Luverne School District Campus. The very edges of the track and field and tennis courts are at the far right of the frame.

Luverne School District about to start new building project; Alumni News looks back on the high school's construction on Highway 75 in 1953

2019 will usher in an exciting couple of years for Luverne Public Schools. The building project that will kick off in the spring will be the first major remodeling project of the high school which was constructed during the middle 1950's. Alumni News thought that you might find it interesting to learn the how and why of that project. The following stories are reprinted from the Rock County

Star Herald. Increasing school enrollment throughout the nation was largely the result of the "baby boom" following World War II. Many local communities were faced with difficult decisions for the future of their school districts. Representatives from the Minnesota Department of Education strongly encouraged consolidation as to the long term answer for these districts. During

the year of 1953 Rock County residents investigated those options.

January 29, 1953 – ROCK COUNTY STAR HERALD:
SCHOOL CONSOLIDATION NOW UP TO REEHOLDERS

Solution of the Luverne consolidation now rests with the

Luverne school 1953/see page 3

Honor Roll of Alumni News contributors

Compiled by Johnna Ahrendt

During this past quarter ending Dec. 31, 2018, the Alumni News received money in the form of memorials, and gifts totaling \$1,717.54. In the memorial section below, the individual being memorialized is printed in bold print, followed by the individual or individuals who made the gift. Contributions given by graduates and friends follow the list of memorials. THANK YOU, READERS!

NOTE:

If you have recently made a contribution to the Alumni News and your name does not appear on this page, please let the staff know. Chances are your contribution was received after this page was compiled. Please watch for the next issue, April 2019, for additional names of Alumni News contributors.

Memorials and contributions may be sent to:

Alumni News
709 N. Kniss Avenue
Luverne, Minnesota 56156

Memorials

Charles Hansen '41

Audrene Hansen - Friend

John Krogmann '45

Connie (Rusche) Wieneke

'58

John Krogmann Family
Keith '49 & Betty (Hansen)

'50 Luethje

Geraldine (DeVries) Hamann '51

James Hamann '56

Sally (Leslie) Phillips '52

Roger '52 & Phyllis (Hagen)

'52 Sherman

Dennis Arp '59

Dennis McIntyre '60

Dianne (Dreessen) Thompson '63

Kathy (Davis) Kelley '63

Virginia (Wharton) Allen '65

Robert Wharton '61

Allan Aust '66

Class of 1966

Jono Bot '74

David Bowen '68

Jeff Bowen '73

Ernie Dahlberg - Teacher

Dennis McIntyre '60

Marge Kilker - Teacher

Dennis McIntyre '60

Class of 1958 deceased classmates

Ronald '58 & Irene
Bowman

Class of 1959 deceased classmates

Evert VanEngelenhoven
'59

Emily Matthiesen - Teacher

Elaine Harms - Teacher

Contributions

Class of 1958

Class of 1963

David Garcia '57

David Odland '71

Donald Wulf '52

Helen (Haggard) Rollag '54

Jeff Bowen '73

Karen (Anderson) Aamot

'61

Keith Loger '69

Ken Bjerk '58

Melinda (Blashill)

Ohlenkamp '96

Sandra Hitch '63

Balance 9/30/18 \$1,088.34

Donations: 1,717.54

DFS Support: 1,250.00

Expenses:

Printing: 919.08

Postage: 1,604.65

Labels: 704.76

Office Supplies: 15.00

Paypal Fees: 9.83

Balance 12/31/18 \$802.56

Contributions

Barb (Johnson) Stensland '73

Dolly Talbert - Teacher

Jerilyn Britz '61

Kathaleen (Doyle) Cox '43

Class of 1958 60th Reunion

Lori (Brandenburg) Bisek '75

Scott Dahlberg '66

Susan (Norelius) Humphrey '60

Wesley Pierson '58

Thank you for your support

Online Alumni News

Have you checked out the Luverne Alumni News at www.alumninews.info lately?

You are able to read your Alumni News online.

It is available to all those that have internet,

let us know you would like to discontinue the hard copy to go green (save postal expenses and a tree).

Please email Patti Pierson at piersonprp@alliancecom.net



The east side main entrance of Luverne High School Middle School looks mostly the same as it did when it was first constructed in the 1950s. After the new project is complete, the main entrance will be on the south side of the complex.

Luverne school project in 1953/continued from page 1

freeholders (*this term was used to describe "landowners" in areas not within a consolidated district*) in the rural school districts, it was stated by B. M. Hendrickson of the State Department of Education before a citizens committee of rural and Luverne persons Monday night.

The meeting marked the third at which Hendrickson has spoken to the citizens committee outlining the problems of the school districts and how best to solve the growing problem of finding more room for the increasing enrollment of pupils.

Members of 16 rural school districts and seven Luverne civic and fraternal organizations made up the group which will seek to get 25 per cent of the signatures of freeholders in order to call an election on a proposed school addition and consolidation.

Under state law 25 per cent of the freeholders in the rural districts must be secured before an election is callable, Hendrickson told the group.

Hubert Swanson, architect hired by the local school board reported on the results of his study of what additional school facilities will be needed.

He estimated a new high school and remodeling of the present high school to an elementary building would cost \$1,400,000. Swanson said this would include complete equipping of the new high school and the change-over of the present Luverne high school to an elementary school.

The money would be raised by the sale of bonds which would be retired in 25 or 30 years at an approximate cost of \$83,000 to \$91,000 per year. This cost would be raised

through a mill levy which would be approximately 21 to 23.5 mills, depending on the number of years to pay off the bonds.

According to one plan submitted by the architect the new high school would take in grades seven through 12 and would be a two story building. It would have three wings joined together.

The wing housing a shop and gym section and band room would be one story high. The building would be modern and be of the latest design in schools, Swanson said.

The citizens group unanimously agreed to have the county superintendent submit a plat to the commissioner of education. This is the first step of any proposed consolidation, Hendrickson said, and does

Tom Getman, Class of 1959 and “proud former citizen of Luverne and grateful graduate of LHS” shared the following with the Rock County Star Herald and Alumni News:

Your long time readers (who would be amongst those who still remember my family) might be interested in the attached which I prepared for the “Getman News” which goes to more than 20,000 Getmans across North America who are progeny of our original refugee indentured-servant-to-the-British Crown grandfather Frederick who arrived in 1710.

He and his mother settled in the Mohawk River Valley of New York State. He purchased a 600-acre farm from the Iroquois Native Americans.

Seven other family members died on the ship of a contagion and were buried at sea. They were escaping the religious persecution, and post Thirty Year War famine, in southwest Palatine Germany via Queen Anne’s refugee camps in London. And of course were spared the future German wars.

It is an interesting “roots” story and we continue to rejoice as the Psalmist, that a “Delightful country has fallen to my lot; lovely indeed is my estate; I (we) bless the Lord who has guiding me (us).” (Psalm 16:6-7, From the Jewish Tanakh Translation)

Of course one of the pleasant places where our boundary lines fell to us was Rock County Minnesota ... which prepared me well for living and working in many places around the world.

Pictured on the adjacent page is a photo of Clara Mains Getman, Mom/Grandmother/Great

4

Let's Hear from YOU!

Let us know what you are doing and we'll pass it on to other alumni. Include your **name, year of graduation, address, phone number and email** (also let us know if you would like your email in our directory of alumni).

Send your news to:

**Alumni News
709 N. Kniss Avenue
Luverne, Minnesota 56156**

Or email luvernechamber@co.rock.mn.us

Grandma's 100th Birthday party on December 29 in Rehoboth, Delaware, with 50 of her four of five children and 37.5 grandkids, plus in-laws and a few other long time “adoptees,” such as Scott Dahlberg, eldest son of the late Ernie and Donna of Luverne.

She lives vibrantly at The Brandywine Senior Center. Three-quarters of those pictured are Getmans from her four sons and many grandsons. The other quarter comprise children and grandchildren of Cynthia Getman Benjamin of Ocean View, Delaware.

With so many male heirs it is no wonder the name continues to proliferate from the humble and singular 1709-10 beginning. Of the four siblings Thomas R, James R, Cynthia L, Charles E and William Frederick all but Jim (who is recovering from heart-surgery in Greeley, Colorado) were present. Jim's three children and a grand daughter attended.

Jan. 2, 1919, was Clara's actual birthday in Seymore Indiana. She grew up in Phoenix Arizona, married in 1940 my dad Dr. Gerald Nathan Getman (died in 1990,

Waldorf, Maryland), son of Dr. Nathan Earnest Getman (died in 1957 in Rock Rapids, Iowa) and grand son of Richard Getman (died in 1924 in Larchwood, Iowa)... from George who was the first born of 4 sons and 3 daughters of our great great, etc, grandfather progenitor Frederick (died 1789, Stone Arabia, NY).

Sister Cindy, brother Chuck and I with spouses plan to be at the August “all” Getman 2019 NY reunion. Cindy is the mom/grandmom of the other one-quarter of this crowd and is sitting immediately in front of Mom. I'm standing on the far left and our first-born son and the first born grandchild of Jerry and Clara, Andrew Fisher Getman, is on the far right.

Andrew, Grandma Clara and I had an instructive time in Mohawk-Stone Arabia, NY, and surroundings in about 1991-2. We were taken round ironically by T. (Thomas) Richard Getman, with a stop at the family homestead to meet the two maiden aunts who urged us to buy the last section of the original homestead (sadly unsuccessfully).

The two ladies looked identical



to my Aunt Lola Getman McNerney, also formerly of Luverne, who was my dad's only sister of five siblings.

Tom Getman is a member of Rock County's Hall of Fame for his work as director of International relations for World Vision International, which works to bring broad relief

and development perspective to foreign policy of various government agencies, including the White House.

Getman's overseas work was mostly in Uganda, South Africa, Palestine and Geneva. He focused on relationship building with senior diplomatic national government and faith leaders to bring them the perspective of the "bottom billion" of the world's citizens.

His most notable efforts were assisting post-apartheid South Africa, a widely circulated and published "reflection" from the five years of service in Israel and Palestine, and the diplomatic negotiation that returned World Vision International to Northern Sudan after a 15-year hiatus resulting in saving countless lives in Darfur.

Remembering our Classmates

Compiled by Carol Schumacher Serie

1940 -1949

Dr. Bryce A. Gilbertson '43 passed away on December 12, 2018, in Dellwood, MN. Dr. Gilbertson enlisted in the Navy at age 17 and was a Hellcat fighter pilot as WWII concluded. He remained in the Naval reserve until 1952.

Bryce married Jeanne Swoboda in 1949. He completed Dental School at the University of Minnesota and practiced oral surgery in St. Paul for over thirty years. An active outdoorsman, he sailed across the Atlantic in a 34-foot boat with three friends at age 63.

Dr. Gilbertson is survived by Jeanne, his wife of 68 years, son Peter (Mary) Gilbertson of Dellwood, son Jeff Gilbertson of Boise, ID, sister **Faye '48** Sahr of Minneapolis, and five grandchildren. He was preceded in death by sisters Hope Herzfeldt and **Donna '44** Schmidt.

John Krogmann '45 died October 16, 2018, in Luverne. John married Imogene Lemke on August 29, 1948 and began farming. In 1992 the couple moved to Luverne. He drove school bus and helped local farmers with planting and harvesting. John helped start the Rock County Pork Producers.

John is survived by his wife, Imogene, Luverne; daughters, **Penny '67** (Mike Godes) Krogmann, Mendota Heights, and **Tammy '76** Krogmann, Montgomery Village, MD; two grandchildren; four great-grandchildren; two sisters-in-law, Joycelyn (Milton) Abraham and Helen Krogmann; and brother-in-law, **Keith '55** (Johnna) Lemke. He was preceded in death by a sister, Lucile Akkerman; two brothers, George and Lorenz, and two infant brothers.

Donald Schmuck Sr. '45 died November 14, 2018, in Ellsworth, MN. Don married Viola Stuckenbroker on May 7, 1947, in Luverne. He worked for A.R. Wood and McClure Plumbing. The couple moved to Minnetonka in 1981, where they managed a condo for ten years. In 1991 they retired and moved back to Luverne.

Don is survived by four children, Don Schmuck Jr., Omaha, NE, **Marilyn '67** Schmuck, Luverne, **David '70** (Ava) Schmuck, Fairview Heights, IL, and Doreen Milstead, Kingston, WA; five grandchildren; eight great-

grandchildren; a brother, Wallace (Verna) Schmuck, Luverne; and a sister, **Judy '58** (James) Hagen, Sioux Falls, SD. He was preceded in death by his wife, Viola; a son, Dennis; a great-grandchild, Heidi Milstead; a sister, Helen Gamsby; and three brothers, Herbert, Henry and Robert.

1950 – 1959

Sid Qualley '52 passed away August 31, 2018, in Plum City, WI. Sid joined the U.S. Air Force at 17 and served during the Korean Conflict. He married Marilyn Davis on May 21, 1955, in Garretson, SD. They lived in several areas before settling in Eau Claire, WI, in 1976. Sid was a salesman for National Cash Register and several other companies. He retired and drove school bus for 14 years.

Sid is survived by his wife, Marilyn; children Scott Qualley, Arkansaw, WI, Carol (Darren Paulson) Laschinger, Arkansaw, WI, and Karen (Kelly) Golden, Colorado Springs, CO; six grandchildren; and three great-granddaughters. He was preceded in death by his brothers and sister.

1960 -1969

Albert DePauw '61 died October 11, 2018, in Sioux Falls, SD. Albert began working for Klein Amusements at age 16 and then spent the rest of his working life in the printing industry, retiring in 2008.

Albert married Joyce Veld on September 8, 1962, in Chandler, MN. They made their home in Sioux Falls. He coached youth basketball teams and volunteered for the Tri-State basketball tournaments for over 30 years, ending in his induction into the YMCA Tri-State Hall of Fame.

Albert is survived by his wife, Joyce, Sioux Falls; daughter Dawn (Todd) Heerde, Sioux Falls; son, Duane (Jennifer), Brandon, SD; seven grandchildren; seven great-grandchildren; sisters **Sheila '69** (Steven) Kluever, Worthington; brothers, **Dean '67** of Wisconsin, **Burdette '73 (Maxine '72)**, Gurnee, IL, **Dale '53** of California, and **Dennis '58**,



After the new Luverne High School was built in 1953 along Highway 75 in Luverne, the school on Luverne Street (pictured here in 1947) became Luverne Elementary School and served as such until 1998 when Luverne School District added the new elementary school to the west side of its existing campus at Dodge Street and Highway 75.

Luverne school project in 1953/continued from page 3

not bind any district one way or the other.

A plat is a map which is prepared by the county superintendent and sent to the state commissioner of education. The plat would show what districts would be included in the consolidation. This plat is necessary according to the law. It could be revised and changed.

Districts which will be included in the first plat submitted to the state commissioner are 3, 4, 6, 10, 11, 12, 13, 16, 24, 28, 29, 43, 46, 50, 59, 74 and the Luverne district.

"The school problem in this area is so big that no one district can handle it alone," Hendrickson said. "We can't stick our heads in the sand and hide...the youngsters are here, now we've got to find a place to send them to school," he declared.

Most of the ungraded schools in rural districts are all very old and no adequate to take care of the increasing enrollments which are coming up, he stated. "The most economical way for all concerned is in consolidation so that all may benefit from the efforts of all," he said.

Under the proposed consolidation the problem would be answered once and for all, he said. All future expansions are taken care of under this consolidation.

"Some of the districts may think that they can get by cheaper if they building their own school building at a cost of about \$30,000," Hendrickson said, "but they would still have a one room school and outside toilets and not have the modern facilities of a high school for their children."

The election would be held at one place and at that time all legal voters in all the districts are eligible to cast their vote. The results of the vote will determine if the consolidation will go through.

May 7, 1953 - ROCK COUNTY STAR HERALD

SCHOOL CONSOLIDATION PLANS

GOING AHEAD

Architect Outlines Four Possibilities
A.G. Weigleitner, representing the firm of

Jacksonville, FL. He was preceded in death by brothers **Delbert '71**, **Butch '64** and **Keith '56**; and sisters Delores Kasemodel, Eileen Roemeling and **Marlys '55** Engel.

Mary Jane (Scheidt) Bullerman '64 died November 10, 2018, in Thief River Falls, MN.

Mary Jane married Allen Bullerman on November 21, 1964, in Luverne. She worked at Campbell's Soup, Lake Haven Nursing Home, and St. Mary's School in Worthington.

Mary is survived by her son, Michael of Woodbury; two brothers, **Larry '67** (Gina) of Rochester and **Timothy '76** (Susan) of Warsaw, IN; brothers-in-law and sisters-in-law Richard (Mary Lou) Bullerman, Chaska, Steve Bullerman, Burnsville, Mary Kay (Michael) LaRocca, San Jose, CA, Shirley Vaselaar, Adrian, Rose Haycraft, Hixson, TN, Karen Bullerman, Worthington, Patricia Scheidt, Luverne; and many other relatives. She was preceded in death by her husband, Allen; a sister, **Beverly '62** Snider; a brother, **Tony '69** Scheidt; sisters-in-law Joan and Beverly Bullerman; brothers-in-law Charles Bullerman, Gary Snider, Arthur Haycraft, John Vaselaar; and a nephew, Todd Haycraft.

Virginia (Wharton) Allen '65 died October 5, 2018, in Sioux Falls, SD. Virginia attended Worthington Community College and then the University of Minnesota Duluth, graduating in 1971 with a degree in education. She moved to Georgia where she taught at various schools including Newman Christian School, Newnan, GA. Virginia married John Allen in 1989 in Senoia, GA. After retiring in 2008, they moved back to Luverne. In 2016 Virginia became a resident of Tuff Memorial Home, Hills, MN.

Virginia is survived by her husband, John; brother **Robert '61** Wharton of Luverne; and other relatives and friends.

Allen Aust '66 died September 15, 2018, in Mankato, MN. Allen received degrees from Worthington State Junior College and Mankato State College.

He married Joan Erickson on October 5, 1974, in Mankato. He worked for Pyramid Life Insurance and then later established Al Aust Insurance Agency. He also worked at Matt J. Graif and Mankato East High School, retiring in 2014.

Allen is survived by his daughters, Melissa (Coty) Aust and Leah Aust; one grandson, Tyler Aust; and brother **Larry '70** (Annette) Aust. He was preceded in death by his wife, Joan.

Judith (Ossenfort) Reis '69 passed away October 14, 2018, in Columbus, GA.

She worked with Bob Carter Enterprise, managing the property and serving the residents of Pembroke Apartments for 45 years. She was a longtime member of Columbus Apartment Association and Hope Harbour Battered Women's Shelter – Ladies Auxiliary.

Judith is survived by daughter, Kim (Kevin) Adams; sons Craig (Katy) Palmer and Ryan (Linsey) Reis; nine grandchildren; siblings **Don '61** (Barb) Ossenfort, **Rodger '68** (**Dianne '68**) Ossenfort, **Lois '62** (Norman) Nath, **Carol '63** (Virgil) Oltmans, **Debbie '70** Gehrke, **Linda '67** (Gene) Molden, **Alice '65** Hansen, **Brenda '73** (Keith) Staeffler, **Kathy '74** (Keith) Scholten; and sisters-in-law Diane Ossenfort and **Marcia '63** Ossenfort. She was preceded in death by **Denny '72** Ossenfort, **Larry '65** Ossenfort, Loren (Grace) Ossenfort and David (Linda) Ossenfort and David (Linda) Ossenfort, her sister Marlene (Lyle) Lundgren, and brothers-in-law Roger Gehrke and **Ronnie '62** Hansen.

Are you getting more than one (1) Alumni News at your house?

If so, please call Patti Pierson at 507-669-2371 or email her at piersonprp@alliancecom.net with the correct postal and email address of your children. Thank you



© 2018 JLG ARCHITECTS

Architect renderings courtesy of JLG Architects

This architectural rendering issued in April shows a possible outcome for the Luverne Middle-High School's front entrance. Luverne School District voter-approved building project is moving forward again after the Dec. 19 bid opening revealed construction costs within the \$23.7 million budget.

Luverne school project in 1953/continued from page 7

Hubert Swanson, architects, speaking at the consolidation study meeting here Monday night gave those in attendance an idea of what the new facilities will be needed.

He suggested four possibilities. He proposed adding to the present grade school (*which was located at the present site of Dingmann Funeral Home*), adding to the present high school (*now City Centre Apartments*), building a new elementary school or building a new junior-senior high school and using the present high school for an elementary school and abandoning the present grade school.

The last suggestion, he said, would be the best plan and would take care of the school problem once and for all. Such a plan would give all children, from grade school to high school all the benefits of the best in educational facilities, including all the academic subjects, recreational facilities, one central mode of transportation, home economics and shop rooms, libraries, gyms, etc.

In regard to the building, there would be required a 2.1 mill rate to retire each \$100,000 over a period of 25 years or 1.9 mills to retire each \$100,000 over a period of 30 years, based upon the assessed valuation of this study of

\$3,331,217. The architect estimated the cost of a junior or senior high unit at \$850,000. This would mean the continued use of two floors of the present grade school for either junior or senior high and necessary grade rooms, and a new junior or senior high school.

The architect has estimated the cost of a complete junior and senior high school at \$1,200,000. This means discontinuance of the present grade building and a new junior and senior high school building. The present high school would be converted to a grade school only.

\$850,000 over a 25 year retirement period would require a 17.8 mill rate, or 16.2 mills over a 30 year retirement period. \$1,200,000 over a 25 year retirement period would require a 25.2 mill rate, or 22.8 mills over a 30 year retirement period. The calculations were based on a 3% interest rate.

In the same issue of the paper, an article was written about the consolidation plan.

Plat of 12 Districts To Be Submitted

A plat, showing the proposed area to be included in the suggested school district consolidation here, will be submitted to the state department of education in the near future.

Eleven rural districts and the Luverne

Luverne school project in 1953/continued from page 9

district will be shown in the map, it was announced at a meeting held here Monday night, which was attended by more than 100 persons, representing the rural districts and the Luverne district. School districts to be included in the plat, which will be prepared by County Superintendent Barrett, will include No. 3, 4, 10, 11, 12, 13, 28, 43, 50, 59, 74 and the Luverne district.

B. M. Hendrickson of the State Department of Education, spoke again on school consolidation as the answer to the growing school problem in Rock county. He reiterated what has been the theme of other consolidated meetings, namely that a severe problem faces the rural districts in the matter of where their children can be properly education. Again he stressed, the increasing enrollment trends, shortage of space and the need to find an answer to the problem now.

"The answer lies with you people," he told the assemblage. "It requires the cooperation of the entire community."

In previous meetings of rural districts with representatives from the Luverne district, much of the ground work was done. A fact finding committee conducted a comprehensive study of enrollment trends, assessed valuations, estimated costs of maintenance and transportation etc.

Assuming that the plat is okayed by the state, the next step is to get petitions circulated in each of these districts for a minimum of 25 per cent of the signatures of the freeholders who reside in the district. Such a petition is necessary to call an election by any qualified voter in the district to decide whether or not their district is to be included in the consolidation.

This election would be held in one central voting place with all districts, with the exception of Luverne, voting at the same time. After the election, it is up to the Luverne school board to accept or reject the vote as taken.

Mr. Hendrickson told the group the matter rested entirely in their hands. "Thus far, facts have been gathered all pointing conclusively that a solution to the school problem exists now," he declared. "Do we want to maintain what we have now?" he asked. "Such an action will not be the answer, because in a few years the problem will grow larger and the expense to add to or rebuild in separate districts will have been lost."

Some ungraded schools are 50 years old and older, the survey taken by the fact finding committee disclosed. This is true in 30

per cent of the districts in Rock county and most of them of wooden frame construction. Some districts could build or modernize their present building but would the district have the enrollment to sustain it, Mr. Hendrickson asked. "As an individual district do you have the sufficient funds to solve your particular problem?" he asked the group. "Alone, no...but together in a consolidated district, yes." Pointing out that the legislature recently passed laws which would allow a hike in the county tuition from \$185 to as much as \$210 in the grades, and junior and senior high up to \$315 in that bracket.

July 9, 1953 - ROCK COUNTY STAR HERALD

11 Districts Will Vote On Consolidation Tonight

Residents of 11 school districts in the Luverne area will vote tonight whether or not they wish to consolidate with Independent School District No. 2 of Luverne.

The election will be held in the high school gymnasium here from 7 to 10 p. m. All persons entitled to vote in a regular school district election in any of the 11 districts are eligible to cast his ballot on the question tonight. Districts are Nos. 3, 4, 10, 11, 12, 13, 28, 43, 50, 59 and 74.

The election comes after about two years of study and planning on the part of the Luverne district and the districts in the immediate area, and its outcome will have a definite bearing on the contemplated building program, the size of the proposed new school building here being determined by the area it must serve.

If the consolidation is approved, it would give the Luverne school district an assessed valuation almost double that which it is now. The present valuation is \$1,968,157 and it would increase it to \$3,331,217, an increase of \$1,363,060. The Luverne district now contains nine sections of land. With the addition of the 11 districts, the area comprised by the district will be approximately 85 sections of land.

July 16, 1953 - ROCK COUNTY STAR HERALD

School Board Here Decline Approval of Consolidation

The members of the Board of Education of School District No. 2 has declined to approve the consolidation with school districts, 3, 4, 10, 11, 12,



Architect renderings courtesy of JLG Architects

This is a conceptual of the new middle-high school cafeteria-commons as it could be viewed from the northeast corner facing southwest. It shows windows facing out to Dodge Street with the building's new main entrance located to the far left. According to the plans, the new performing arts center entrance would be located off to the right.

Luverne school project in 1953/continued from page 10

13, 28, 43, 50, 59 and 74.

The election was held on the proposal last Thursday night and the vote was 86 in favor of the consolidation with 85 opposed. The board took the attitude that with the close vote it was unable to definitely determine the wishes of the public regarding said consolidation.

"We would never want to go ahead with such a consolidation on the basis of a one vote margin," said Elmer Piegras, board clerk, who acted as spokesman for the Luverne group.

It was indicated that another election will undoubtedly be called. Action on such a proposal will have to be initiated by Albert Christensen who has served as chairman of that committee during the past year.

The members of the Luverne board met Monday night with the members of the rural school boards. Members of the other boards concurred in the thinking that the Luverne board was following a wise policy in declining to go ahead with the results of last Thursday's election. A copy of the resolution passed by the Luverne board, was mailed to County Superintendent

Barrett at Salinas, California, where he is on a vacation.

The local board did not comment on the two votes cast by ineligible votes. Ernest M. Hamann, who was elected chairman of the organization meeting before the election Thursday night, said it was learned after the voting had been completed that two persons had voted who were not entitled to vote.

While they owned land in district No. 3, they did not reside in the district, and therefore could not qualify as legal voters.

Serving as clerk at the meeting was Hugo Juhl. Appointed to serve as judges were Dick Richters, District 3; Ernest M. Hamann, District 4; Henry Ehlers, No. 10; Hans LaFrenz, No. 11; Hugo Juhl, No. 12; Henry Wiese, No. 13; Paul Iverson, No. 28; Cletus Lynch, No. 43; Herb Kiebach, No. 50; Henry LaFrenz, No. 59 and Fred Jauert, No. 74. Julius Jessen and Vernon Noll served as tellers.

Luverne school project in 1953/continued from page 11

September 10, 1953 – ROCK COUNTY STAR HERALD

Luverne School Shows Big Gain – Total of 930, An Increase of 61, Reported Here by Superintendent Eitreim

Supt. Harvey G. Eitreim knew Tuesday just how the “old lady who lived in a shoe” felt when she had so many children she didn’t know what to do. He had a general idea of how large the enrollment would be in the Luverne public schools, but the registration even exceeded his maximum estimate by about 15 pupils.

The enrollment jumped 61 pupils over last year’s previous record high. That’s the equivalent of two more classrooms full, but there weren’t two extra classrooms available, so they had to be crowded in to the present bursting-at-the-seams facilities.

When the count was tabulated Tuesday night, the adding machine showed that the Luverne public school had 930 pupils. This compares to 869 in 1952. That there may be a few who may have been absent the first day is entirely probably, and this means the total will likely be larger still. New families moving into Luverne and closing of several rural schools accounted for the unexpected increase.

Most of the pupils are in the lower grades. For instance, there were 87 in last year’s kindergarten classes. But when it came to enrolling this year’s first grade, there were 107, to make it the largest grade in the entire school. This year there are 91 in kindergarten; and 79 in the second grade – the same number as were in the first grade last year.

Other grades showed enrollments of 65 in the third, 60 in the fourth, 65 in the fifth; 58 in the sixth, making a total of 434 in the first six grades, an increase of exactly 60 over last year’s total of 374 for those same grades.

The junior high enrollment took a slight drop, however, this year’s figure being 201 compared to 211 last year. There are 56 seventh graders, 72 in eighth grade and 73 in ninth grade. In senior high, there are 204 students, an increase of seven over one year ago. This year’s sophomore class number 84, the junior class is 53 and the senior class is 67.

State regulations provide that in elementary grades, there should not be over 35 in a class room and in high school not over 30.

Yesterday, Supt. Eitreim said that the increased enrollment would make necessary the purchase of a number of new desks and other equipment to accommodate the increased enrollment. The board has also discussed the possibility of hiring an additional first grade teacher in order to achieve an ideal teaching situation here. However, no definite decision has been reached as yet, Supt. Eitreim stated.

Only Choice If Consolidation Fails 2nd Time

The Luverne School Board took a quick and startled look at the opening day enrollment figures and realized that the Day of Decision is closer at hand than they had feared. They heard the report that the unexpected increase was necessitating getting extra desks, perhaps an extra room or two and an additional teacher.

The unpleasant decision they are facing is the realization that they will have to exclude all rural pupils from the schools. In the event that the consolidation effort might fail some board members indicated there could be only one immediate choice – meeting the obligation of taking care of Luverne pupils first.

The citizens consolidation committee got concrete evidence of what the trend in enrollment is going to be in the next few years when they were informed that enrollments at the Luverne school for the opening day here increased by 61 pupils over last year. The immediate problem facing the Luverne school board is where to put the extra students. Superintendent Harvey Eitreim got 17 more students in the first grade than he expected.

It was brought before the consolidation committee that should a second consolidation vote fail, then there would be no other alternative for the Luverne school board except to “take care of their own first.”

What this would mean to rural districts is definite and final.

“The consolidation problem is the problem of the rural districts, not of the Luverne district,” it was declared. “We need room and need it badly.”

And the problem won’t take care of itself anymore. The Luverne school board has to find room for the extra first grade students. This means finding another classroom, hiring another teacher and buying additional desks.

Watch for the spring edition of Alumni News when you can read more about the decisions that were made by the citizens of Rock County!

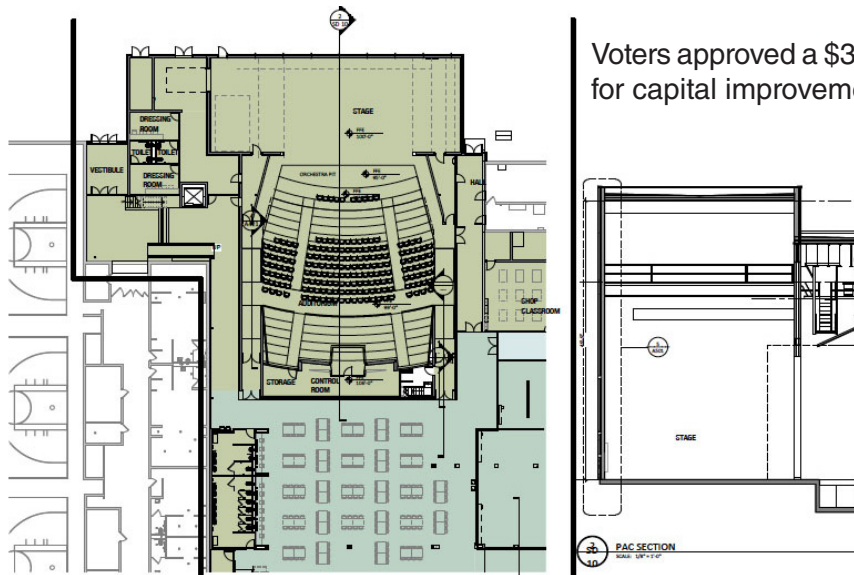

Voters approved a \$31 million school referendum last year for capital improvements and facility expansions.

They approved two ballot measures, \$16 million to improve the 1950s-era high school buildings, \$7 million to build a new performing arts center and \$8 million for health and safety improvements.

The shaded portion in the top of the graphic shows the performing arts center, adjacent to the new commons and new primary entry to the south.

LUVERNE SCHOOLS ADDITION AND REMODEL

MUSIC/PERFORMING ARTS
4.12.18 | JLG 17047 | © 2018 JLG ARCHITECTS

(This image was an early draft and may not reflect the current plans.)

School project back on track after bids come in under budget

This story appeared in the Dec. 27, 2018, Rock County Star Herald

By Mavis Fodness

Luverne School District building project is moving forward again after the Dec. 19 bid opening revealed construction costs within the \$23.7 million budget.

A special school board meeting was scheduled for 6 p.m. Monday, Jan. 7, to formally award bids.

The recent bid opening had three general contractors submitting costs to remodel/refresh the middle-high school as well as add a new student commons area and performing arts center.

Bids ranged from \$20.9 million to \$22.375 million.

The project has a budget of \$23.7 million.

Based on the submitted bids, the board could allocate the remaining \$2.3 million toward the contingency fund or toward the alternate bids or value-engineered materials.

One alternate for a new mechanical control system (\$438,740) will be added. The system is necessary to connect the new to the existing mechanical systems.

All six alternates could

be afforded if the board chooses to accept all of them.

Included in the alternates are an additional 1,000 square feet to the new commons area, two additional classrooms in the north wing and use of terrazzo tile in the commons.

The favorable budget numbers revealed at the most recent bid opening were a relief to project managers.

"We got a win," said Todd Wetzel with ISC Consulting.

"We can now decide what we can add in."

Project stalled in August with project over budget

The Dec. 19 bid opening was the third such event for Wetzel, ISC Consulting personnel and JLG Architects.

The first bids were opened July 24, totaling \$2.4 million over budget.

The second opening was a re-bid for electrical estimates when no company submitted a bid for the work during the initial bid process.

A single electrical bid was received Aug. 16 and jumped the project to \$3 million over budget.

When costs couldn't be brought into budget through the value engineering process, school board members rejected all bids and set about revising the scope of the project.

The result was a refocus on the improvements to the 62-year-old middle-high school. Any plans to upgrade the 20-year-old elementary school and community education facility were dropped.

When the third bid request was established, it called for a general contractor for the project and included alternates that could be added to the base bid if the budget allowed.

Originally, construction was slated to start in September with completion in December 2019.

Completion is now expected for December 2020.

Under the new bid contract, work could be underway in March with the remodel of the middle-high school auditorium for the new vocal and instrumental music classrooms.

Construction on the new middle school-high school commons and performing arts center could begin in May.



4th grade teachers, Deb Hoogendoorn and Jennifer Engesser, with two of the chromebooks they were able to purchase with their LELF grant.

New name, new website; Luverne Education Legacy Fund launches new website to reach students and alumni

The Luverne School Foundation is now the Luverne Education Legacy Fund (LELF).

While the name has changed, the mission of the organization remains the same: to enhance educational opportunities for today's students.

Along with the new name comes a new website, which can be found at <http://www.luverneeducationlegacyfund.org>.

The new website includes information about the Fund and various projects at Luverne Schools that

have been funded by the LELF.

Those who wish to make financial donations to the LELF can do so online as well via the Luverne Area Community Foundation (LACF) website at <http://www.luvacf.org>. Donors should designate their gifts to the Luverne Education Legacy Fund.

Supporters who wish to make a donation by check should write the check out to LACF and in the memo include "Luverne Education Legacy Fund." Checks may be sent to P.O. Box 623, Luverne, MN 56156.

Help us keep a good thing going; Alumni News is a worthwhile cause to support

The Alumni News is published by volunteers as a free gift for Luverne High School alumni who enjoy the quarterly updates on classmates and their hometown. This publication is the envy of school districts everywhere, as it also maintains a priceless database of our alumni dating back to classes that graduated decades ago. There are expenses incurred with printing, mailing and database support, and these costs are paid for with generous contributions from our alumni and readers.

Today, it's easier than ever to support our efforts with your donations.

Memorials and contributions may be sent to:

Alumni News, 709 N. Kniss Avenue, Luverne, Minnesota 56156.

OR donate online, www.alumninews.info and click on the **DONATE** button.

Reunions in the Making

Please send change of address to Alumni News or email: piersonprp@alliancecom.net

ARE YOU PLANNING A CLASS REUNION? Email Patti Pierson at piersonprp@alliancecom.net and she will be able to provide you with a class listing and also labels.

CLASS OF 1969 50th Class Reunion May 31– June 1, 2019

FRIDAY

Meet at the Buffalo Days Cruise-in
from 6 to 9 pm
with another "Social Hour" at Take 16
beginning at 9 pm

SATURDAY

Trolley Tour at 1 pm
9 Hole Golf Scrambler at 2:30 pm
Reunion Dinner 6 pm
at Luverne Country Club

Enjoy all the activities going on with
the Buffalo Days Weekend!
Check out our Facebook Page
"LHS Class of '69"!

Packets with more info will be
sent out in late January!

Information & contacts:

Lorna Siebenahler Bryan
lornabryan@alliancecom.net

Janine Jordahl Papik
janinepapik@hotmail.com

CLASS OF 1979 40th Class Reunion August 2-3, 2019

FRIDAY

Gathering and Social Hour
Starting at 7 pm
Take 16 Brewing Company

SATURDAY

Golf Scrambler
Bison Tour at BMSP
LHS Tour
History Center & more!

Reunion Dinner 6 pm
at Luverne Country Club
catered by Bluestem Catering

More information coming!

Watch your email & check out Facebook
"Luverne MN Class of 1979"

Information & contacts:

Laurie DeWispelaere
306-547-2467

laurie_dew@yahoo.com

Colleen Deutsch
507-227-6163

colleendeutsch79@gmail.com



CLASS OF 1954 65th Class Reunion September 13-14, 2019

Letter with more info
will be sent in
late January

FRIDAY: Gathering at the GrandStay Hotel & Suites from 2 to 7 pm

SATURDAY: Tour of Historic Palace Theatre at 11 am

Lunch to follow (on your own) at Sterling's Café & Grille

SATURDAY REUNION DINNER: Luverne Country Club at 5 pm

Information & Contacts: Jim Klassen klassen@embarqmail.com
Peggy Schmidt Anderson pegswede36@gmail.com

Notice of Class of 1964 55th reunion: Cloyce Smith announced that the class is planning to have a reunion during Buffalo Days the first weekend in June and more info will come.

Alumni News Staff: Cindy Arends, Jane Wildung Lanphere, Carol Schumacher Serie,
Johnna Ahrendt, Patti Kirby Pierson, Rock County Opportunities and Lori Sorenson.

1304145

Volume 29 Issue 2

Alumni News
709 North Kniss Avenue
Luverne, MN 56156

Luverne
Love the life!

Change Service Requested

Non-Profit
Organization
US Postage Paid
Luverne, MN
Permit No. 115

Place Label Here